

NPS-DN		Class 600lb Dimensions					WT
in	mm	L	H	W	NPT	d	Kg
1/2	15	-	-	-	1/2"	13	-
3/4	20	-	-	-	3/4"	19	-
1	25	-	-	-	1"	25	-

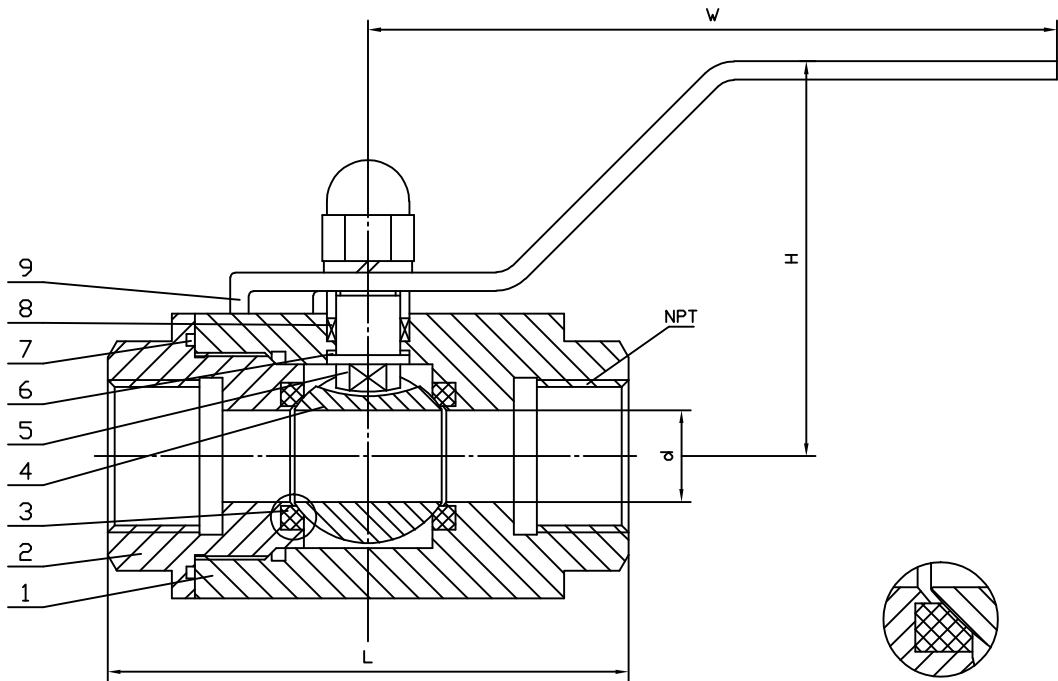

Fire Durable

Notice:

1. Design by API 608
2. NPT Ends to ASME B16.11
3. Valves tested by API 598
4. Fire Durable

NO	REVISION	DATA	NAME
STANDARD			
TEST PRESSURE		SHELL	SEAT
	UNIT	Psig	Psig
	HYDRAULIC		
	PNEUMATIC		

NO	PART NAME	MATERIAL	REMARKS
9	Handle	COMPONENT PART	
8	Packing	PTFE	
7	Gasket	PTFE	
6	Thrust ring	PTFE	
5	Stem	ASTM A276-316	
4	Ball	ASTM A182-F316	
3	Seat Ring	R-Teflon	
2	Cover	ASTM A105	
1	Body	ASTM A105	

BALL VALVE				FIG NO
DESIGN BY			SITASIA SINGAPORE	
CHECKED BY			DRAWING NO	REV
STANDARD BY			(232wzg)	
APPROVED BY				
NO	PART NAME	MATERIAL	REMARKS	DATE
			THE USER CONFIRM	