

2"-24"H44H-300Lb-00

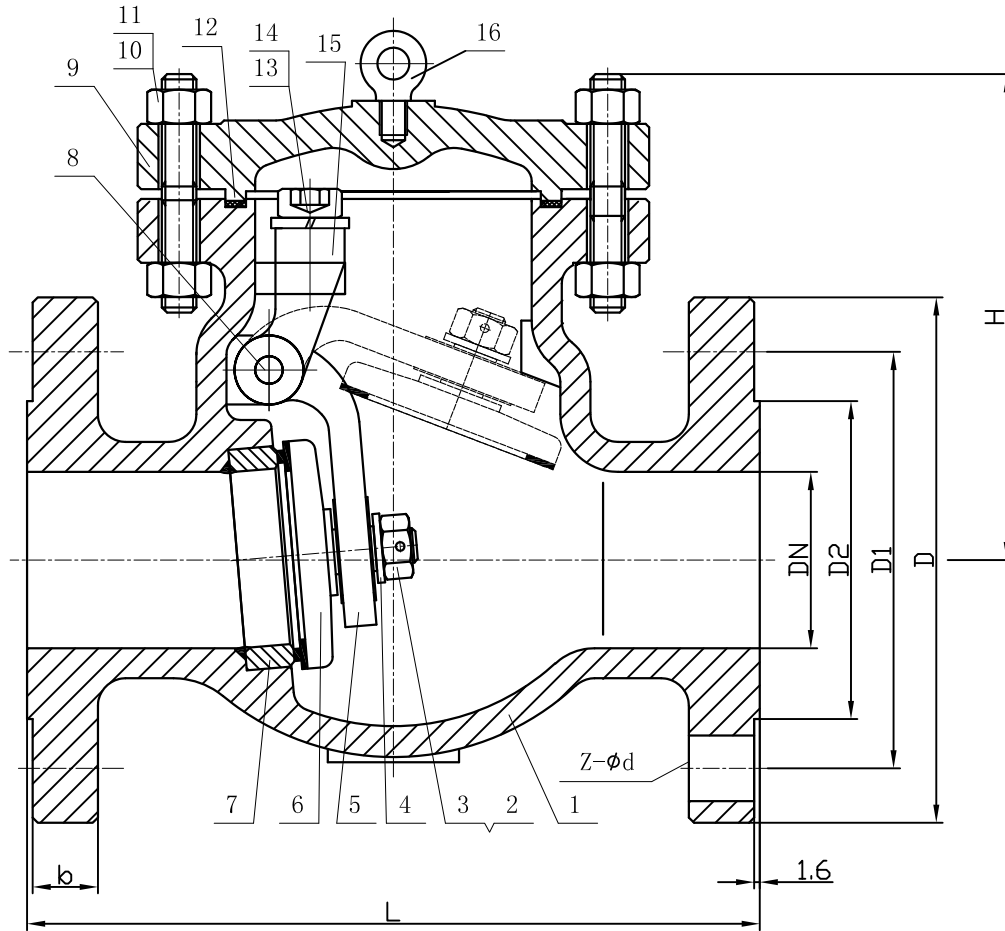

NPS	DN	L	D	D1	D2	b	H	Z-φd
2"	51	267	165	127	92	23	170	8-19
2.5"	64	292	190	149	105	26	185	8-22
3"	76	318	210	168.5	127	29	215	8-22
4"	102	356	254	200	157	32	235	8-22
6"	152	444	318	270	216	37	300	12-22
8"	203	533	381	330	270	42	340	12-25
10"	254	622	445	387.5	324	48	350	16-29
12"	305	711	521	451	381	51	420	16-32
14"	337	838	584	514.5	413	54	480	20-32
16"	387	864	648	571.5	470	58	520	20-35
18"	432	978	711	628.5	533	61	600	24-35
20"	483	1016	775	686	584	64	670	24-35
24"	584	1346	914	813	692	70	750	24-41

No	Designation	QTY	Material	Remark
1	Body	1	ASTM A216 WCB	
2	Valve Nut	1	ASTM A194 2H	
3	Disc Nut Pin	1	SS316	
4	Disc Washer	1	ASTM A276 316	
5	Hinge	1	ASTM A276 316	
6	Disc	1	ASTM A351 CF8M	
7	Seat	1	ASTM A182 F316	
8	Hinge Pin	1	ASTM A182 F316	
9	Cover	1	ASTM A216 WCB	
10	Cover Bolt		ASTM A193 B7	
11	Cover Nuts		ASTM A194 2H	
12	Gasket	1	316+Graphite	
13	Eye Bolt	1	Carbon Steel	
14	Sping Washer	1	Spring Steel	
15	Bearing Bracket	1	ASTM A216 WCB	
16	Stationary Rings	1	Carbon Steel	

SPECIFICATIONS

Nominal pressuer		Class 300	
TESTING PRESSURE	Shell testing	7.7	MPa
	Seat testing	5.6	
	Backseat testing		
	Air seat testing	0.6	
Max, Temperatuer		-29~425	°C

Technical Requirement

- 1.Design and manufacture:API 594
- 2.Face to face : ASME B16.10
- 3.Flanged ends :ASME B16.5
- 4.Testing and checking : API 598

Design proofing				standardization authorized				SWING CHECK VALVE				2"-24"H44H-300Lb-00			
auditing				Ratify											
technics				date											