

Class		900LB	
Test Pre- ssure	Shell Test	22.5	MPa
	Seal Test	16.5	
	Air Test	//	
Suitable Temp		-29°C-425°C	
Suitable Media		W.O.. etc.	

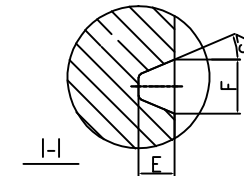

in	DN	L	D1	K	P	n-d	E	F
2	50	70	165.1	124	95.25	8-Ø26	7.92	11.91
3	80	83	190.5	155	123.83	8-Ø26	7.92	11.91
6	150	159	317.5	241	211.12	12-Ø32	7.92	11.91
16	400	384	615.9	524	469.9	20-Ø45	11.13	16.66
20	500	451	749.3	648	584.2	20-Ø54	12.70	19.84

Technical Requirements

1. Design & manufacture conform to API 594
2. Test & Inspect conform to API 598
3. Face to Face dimension conforms to API 594
4. Flange dimension conforms to ANSI B16.5-1998 RTJ.
5. Pressure-Temperature conforms to ANSI B 16.34

Item	Part Name	Material	Notes
7	Retainer	ASTM A193 B8M	
6	Spring Seat	ASTM A182 F316	
5	Gasket	ASTM A182 F316	
4	Spring	INCONEL X-750	
3	Stop Pin	ASTM A182 F316	
2	disc	ASTM A351 CF8M	
1	Body	ASTM A351 CF8M	
DESIGN BY		STV Valve Technology Group Co., Ltd	
CHECKED BY			
STANDARD BY		DRAWING NO	REV
APPROVED BY		H76H-900(LB)C-00	
THE USER CONFIRM		ANSI CHECK VALVE	
		DATE	2011-02-17